



WINSTON

Features: KNIFE EDGE BACK, WELTLESS

STANDARD WITH THROW PILLOWS (not shown)

DUE TO THE SIZING OF THE OTTOMAN, SOLID FABRICS SHOULD BE SELECTED WHEN USING THE OTTOMAN AS PART OF A SECTIONAL. STRIPES AND PLAIDS WILL NOT FLOW-MATCH

Standard Seat Cushion: COMFORT DOWN

Standard Back Pillow: COMFORT DOWN

Standard TP Fill: LEGACY DOWN

	FABRIC/STYLE	OUTSIDE			INSIDE		SEAT	ARM	BACK RAIL	STANDARD TPs (except leather styles)	CUSHIONS
CORNER CHAIR	4900-12	40.5w	40.5D	35.5H	36w	23.5D	19.5H	—	28.5H	1 - 22"	2 OVER 1
ONE ARM CHAIR	4900-18L/R	40.5w	40.5D	35.5H	36w	23.5D	19.5H	28.5H	28.5H	1 - 22"	1 OVER 1
ARMLESS CHAIR	4900-15	36w	40.5D	35.5H	36w	23.5D	19.5H	28.5H	28.5H		1 OVER 1
OTTOMAN	4900-17	40.5w	40.5D	19H							

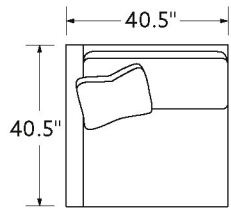

4900-18L One Arm Chair

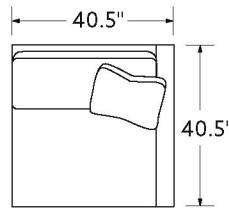

4900-18R One Arm Chair

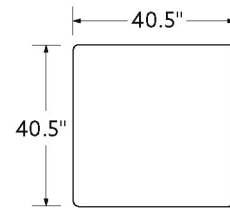

4900-17 Ottoman

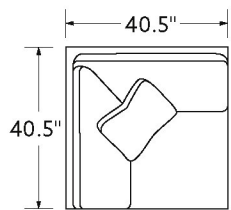

4900-12 Corner Chair

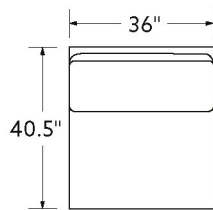

4900-15 Armless Chair

