

Audrina K31600

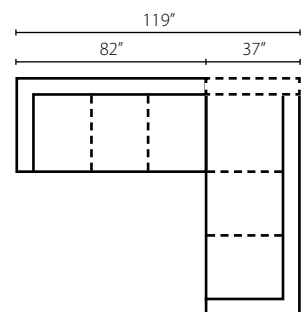

The sweet Audrina collection has curves and style. Sloped track arms are decorated with welt that extend to slender, tapered wood legs. Bordered and welted seat cushions meet bordered and welted back cushions that also have three button tufts on each cushion. Petite rectangular pillows are encased with welt to splash in color and texture. Shown in Capri Ocean and Froufrou Emerald. Loose Back.

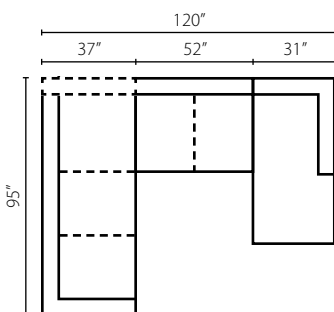
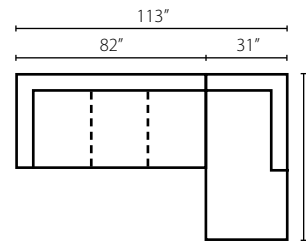
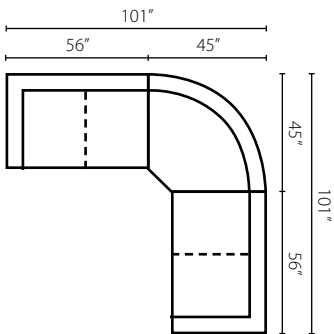
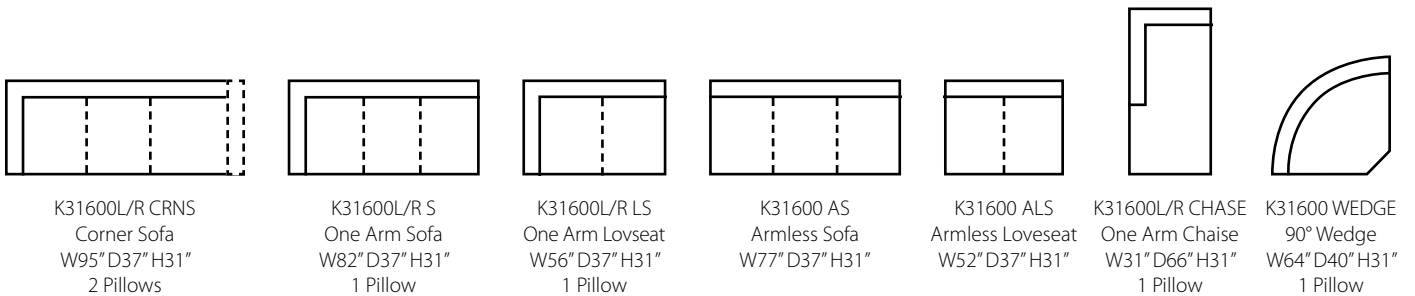

Audrina Style# K31600



Shown in Attire Pear and Spree Indigo.

The sweet Audrina collection has curves and style. Sloped track arms are decorated with welt that extend to slender, tapered wood legs. Three bordered and welted seat cushions meet three bordered and welted back cushions that also have three button tufts on each cushion. Petite rectangular pillows are encased with welt to splash in color and texture.

Sofa Overall W88 D37 H31
Seat W77 D22 H22

Loveseat Overall W63 D37 H31
Seat W52 D22 H22

Chair Overall W37 D37 H31
Seat W26 D22 H22

Ottoman Overall W32 D26 H21

How To Order:
Fabric 1=Body
Fabric 2=Kidney Pillows



Individual items may be discontinued without notice. ~ *Due to printing processes colors may vary from actual cover.